

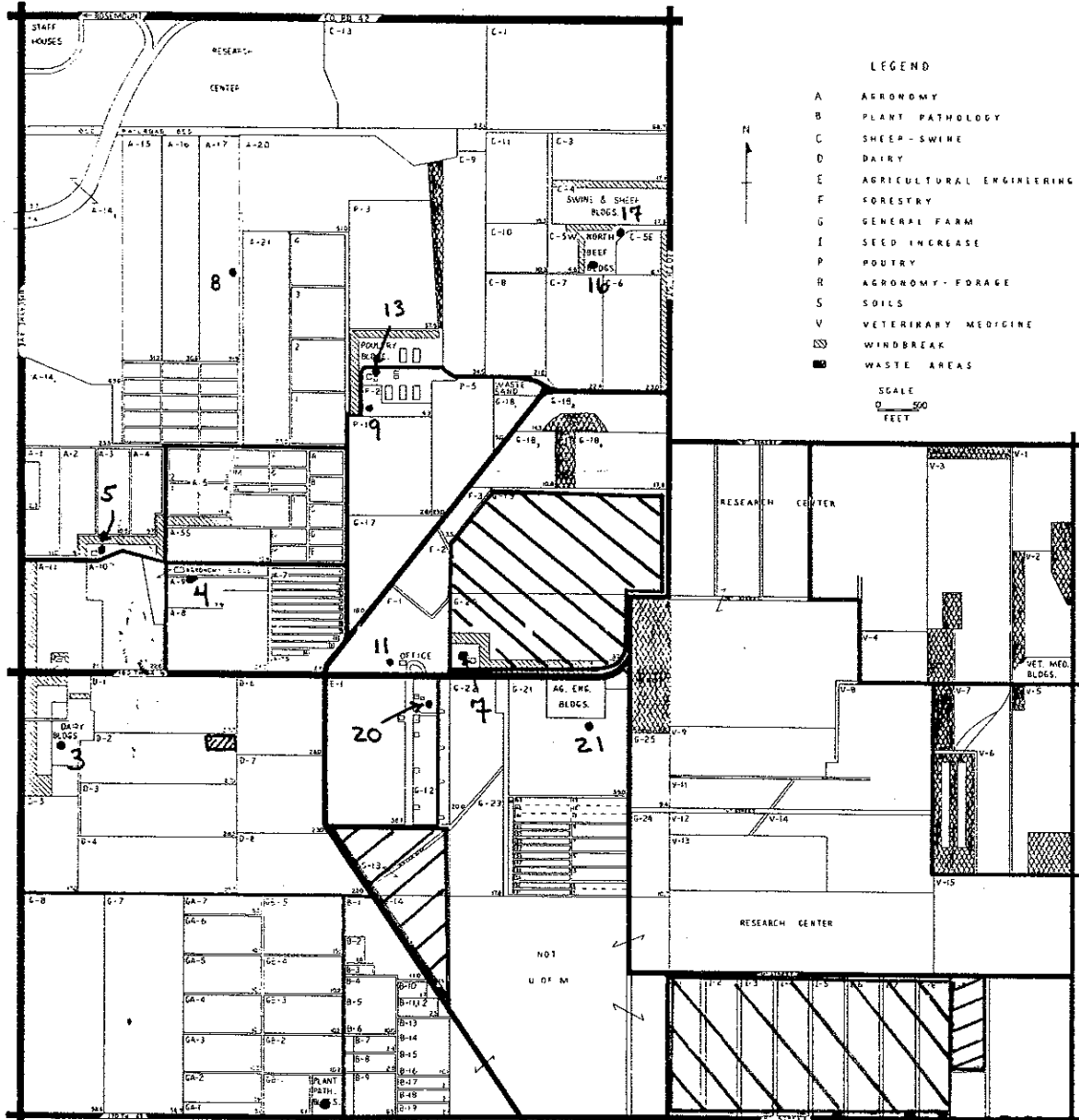

Well Inventory - Agricultural Research Center

<u>Map Designation (#)</u>	<u>Site Description</u>
1*	RRC Well #1
2*	RRC Well #2
3	Dairy Farm
4	Near Elliot Farm (No. 1)
5	Farm House
7	Superintendent's Residence
8	Abandoned Well
9	Poultry Well No. 1 (Field Well)
10	South Beef Farm
11	Office - U of M A.R.S.
12*	(not used)
13	Poultry Farm No. 2
14	Plant Pathology
15*	Swine Farm Field
16	North Beef Farm (old)
17	North Beef Farm (new)
18	Agronomy Farm
19	
20	
21	Agricultural Engineering
22*	Home of Norm Ellingson (Bill Cook)

UNIVERSITY OF MINNESOTA
 AGRICULTURAL EXPERIMENT STATION
 ROSEMOUNT MINNESOTA



Sludge fields- 
 Agricultural Experiment Station Wells- ●
 (Well logs are available)

Sludge Lagoons
 I & II

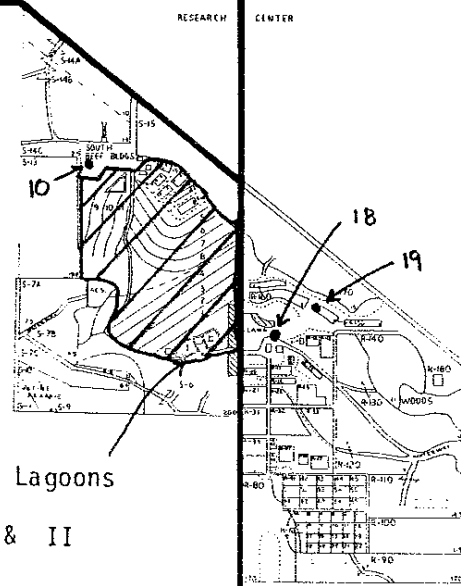

Source: Labro, B.A.

"The Hydrogeologic Implication of
Chemical Disposal in a Glaciated
Terrain, Rosemount, Minnesota,"
MS Thesis, U of M, 1973.

LOCAL STUDY AREA WELL LOGS

LOCATION	WELL LOG	DEPTH	ELEVATION (Feet)
----------	----------	-------	---------------------

T114N, R19W

SECTION: 2 BBD	TEST BORING		933 [±]
----------------	-------------	--	------------------

Sand and gravel	0-49
Brown to dark brown	49-63.5
Clay with a little gravel	
Osp sandstone	63.5-75.1

Source: Britzius (1965)

SECTION: 3 CCD	FARM RUINS		935 [±]
----------------	------------	--	------------------

Sand and gravel	0-50
Osp Sandstone	50-80 [±]

Source: Schwartz (1936)

3BBA	AGRICULTURAL ENGINEERING BUILDING		941 [±]
------	-----------------------------------	--	------------------

Clay	0-18
Sand and gravel	18-60
Clavey gravel and boulders	60-78
Brown clay	78-89
Blue clay	89-130
Clavey gravel	130-139
Brown clavey gravel and boulders	139-151
Opc Limestone	151-206 [±]

Source: Agricultural Station Records

3BBD	DAIRY FARM ✓		954 [±]
------	--------------	--	------------------

Black topsoil	0.0-1.5
Sandy clay	1.5-5.0
Hardpan(?)	5.0-102.0
Sandy blue clay	102.0-125.0
Sandy Brown Clay	125.0-135.0
Fine brown rotten sandrock (Osp?)	135.0-153.0
Fine dirty sand and gravel	153.0-161.6

LOCATION	WELL LOG	DEPTH	ELEVATION
	Opc dolomite	161.6-263.0	
	Dolomite (streaks of sandrock)	263.0-325.0	
	Dolomite	325.0-355.0	
	Dolomite (traces of sandrock)	355.0-366.0	
	Gj sandrock	366.0-429.2	

Source: Agricultural Station Records

SECTION: 4 AAA WORKMAN'S CHANGE HOUSE (1966) 945±

Clay	0-5
Gravel	5-35
Blue clay	35-130
Red clay and sand	130-150
Red clay and gravel, hardpan very hard,	
Opc limestone	150-170

Source: Agricultural Station Records

4 DDB PLANT PATHOLOGY (1961) ✓ 942±

Soil	0-2
Sand	2-72
Sandstone?	72-105
Sandstone and gravel	105-120
Shale ? and gravel	120-130
Sand and gravel	130-148
Opc dolomite	148-340
Gj sandstone	340-415

Source: Agricultural Station Records

SECTION: 10 ACB SOUTH BEEF FARM (1951) 983±

Black dirt	0-3
Yellow clay, some stones	3-22
Dry sand	22-25
Blue clay	25-55
Hardpan	55-110
Sandy clay	110-125
Opc dolomite	125-350
Gj sandstone	350-432

Source: Agricultural Station Records

LOCATION	WELL LOG	DEPTH	ELEVATION
----------	----------	-------	-----------

SECTION: 11DCD TEST BORING

Soil	0.0-4.0	
Light brown medium to coarse sand with a little gravel	4.0-13.5	
Osp light brown sandstone	13.5-17.9+	
Source: Britzius (1965)		

11DCD TEST BORING 923

Soil	0.0-1.5	
Light brown to medium sand with a little gravel	1.5-17.0	
Osp light brown to white sandstone	17.0-20.4+	
Source: Britzius (1965)		

11DCA TEST BORING 922

Soil	0.0-2.0	
Light brown to brown medium to coarse sand with a little gravel	2.0-56.6	
Osp light brown sandstone	56.6-72.8	
Opc light brown dolomite	72.8-77.8	
Source: Britzius (1965)		

11CCB AGRONOMY FARM (1947)

Clay and loam	0-5	
Sand and gravel	5-10	
Dirty sand	10-90	
Osp sandstone (dark)	90-120	
Sandstone (lighter color)	120-140	
Sandstone (lighter)	140-180	
Opc limestone	180-220	

Source: Agricultural Station Records

T115N, R19W

SECTION: 26DAD HOME OF NORM ELLINGSON (1969) 955

Clay	0-20
------	------

LOCATION	WELL LOG	DEPTH	ELEVATION
	Gravel	20-110	
	Clay	110-140	
	Gravel	140-150	
	Clay	150-160	
	Gravel	160-170	

Source: Rosemount Research Center Records

26 DCD ABANDONED WELL (1960) 930+

Sand and gravel	0-75
Blue clay	75-84
Yellow clay	84-90
Sand and gravel	90-130
Opc broken limestone	130-145
Hard limestone	145-156

Source: U.S. Geological Survey, St. Paul Office

26 CCA ROSEMOUNT RESEARCH CENTER 936.5
Well #1 (1942)

Loam	0.0-4.0
Sand and gravel	4.0-110.0
Gravel, some clay	110.0-131.5
Sand	131.5-160.5
Opc sand and broken limerock	160.5-168.5
Limerock	168.5-305.5
Cj Yellow sandstone	305.5-370.5
Gray sandstone	370.5-410.5

Source: Rosemount Research Center Records

26 AAD HOME OF RANDALL HED (1972) 920⁺

Clay	0-145
Opc limestone	145-177

Source: Genz-Ryan Plumbing and Heating,
Rosemount

26 CBC PRIVATE HOME 940⁺

Drift	0-170
Opc limestone	170-215

Source: U.S. Geological Survey, St. Paul Office

LOCATION	WELL LOG	DEPTH	ELEVATION
SECTION:27 ADC	VILLAGE HALL OF ROSEMOUNT (1965)		935 [±]
	Gravel	0-100	
	Osp sandstone	100-120	
	Opc limestone	120-155	
	Source: Genz-Ryan Plumbing and Heating, Rosemount		
SECTION:33 ADB	POULTRY FARM (1960) #2		953 [±]
	Brown sandy drift	0-45	
	Gray clay	45-120	
	Sand and gravel	120-142	
	Osp remnants of		
	St. Peter sandstone	142-181	
	Opc Oneota-Shako-		
	pee limerock	181-350	
	Ej Jordan sandstone	350-432	
	Source: Agricultural Station Records		
33 ABB	FIELD WELL (1959)		954 [±]
	Loam and clay	0-3	
	Sand and gravel	3-60	
	Gravel and clay		
	mixture	60-93	
	Osp sandstone	93-153	
	Opc limestone	153-221	
	Source: Agricultural Station Records		
33 DDD	UNIVERSITY OF MINNESOTA AGRICULTURAL RESEARCH STATION OFFICE (1957)		948 [±]
	Clay, gavel in		
	layers	0-30	
	Clay in layers	30-158	
	Water bearing sand	158-161	
	Opc limerock	161-166	
	Source: Agricultural Station Records		
33 CDB	SWINE AND SHEEP FARM		950 [±]

LOCATION	WELL LOG	DEPTH	ELEVATION
	Sandy loam and sand	0-12	
	Clay-mixed with gravel	12-72	
	Sand	72-92	
	Coarse sand and gravel-dirty	92-102	
	Hardpan	102-116	
	Sand and clay	116-130	
	Clay and gravel	130-146	
	Clay and sand	146-168	
	Opc dolomite	168-273	
	Dolomite (streaks of sandrock and shale)	273-291	
	Dolomite	291-359	
	Dolomite (with sand-rock - gray	359-373	
	Ej Jordan sandrock	373-434	

Source: Agricultural Station Records

SECTION:34 ABA NAVAL ASTRONAUTICS BASE (1968) 930⁺

Top soil	0-2
Sand	2-15
Coarse gravel	15-93
Yellow clay	93-130
Gravel and clay	130-148
Sand and gravel	148-162
Opc broken limestone	162-188

Source: Aamot Well Drilling Co.

34 BAB NORTH BEEF FARM, OLD (1957) 945⁺

Sand and gravel	0-35
Sand	35-50
Sand and gravel	50-75
Sand, gravel, clay in layers	75-100
Water Bearing Sand	100-115

Source: Agricultural Station Records

LOCATION	WELL LOG	DEPTH	ELEVATION
----------	----------	-------	-----------

34 BAA	NORTH BEEF FARM, NEW (1970)		940 [±]
--------	-----------------------------	--	------------------

	Black dirt	0-2	
	Gravel and sand	2-90	
	Blue clay	90-120	
	Water sand	120-134	

Source: Agricultural Station Records

34 CCC	SUPERINTENDENT'S RESIDENCE (1953)		953 [±]
--------	-----------------------------------	--	------------------

	Clay to almost loam at lower depth	0-140	
	Sandy clay	140-180	
	Sand to coarse sand and gravel	180-195	
	Gravel to limestone (Opc)	195-235	

Wood samples were taken from approximately 185-192 feet depth.

Source: Agricultural Station Records

SECTION:35 BAB	ROSEMOUNT RESEARCH CENTER Well #2 (1942)		937
----------------	--	--	-----

	Gray loam	0.0-2.0	
	Sand and gravel	2.0-78.0	
	Hardpan	78.0-80.0	
	Blue clay	80.0-101.0	
	Sandy blue and yellow clay	101.0-110.0	
	Gray sand	110.0-131.0	
	Yellow sand	131.0-153.0	
	Opc rotten dolomite	153.0-154.5	
	Dolomite	154.5-294.0	
	Ej white sandrock	294.0-298.0	
	Yellow sandrock	298.0-353.0	
	Esl gray sandrock and shale	353.0-383.0	
	Gray or blue shale	383.0-390.0	

Source: Rosemount Research Center Records

LOCATION	WELL LOG	DEPTH	ELEVATION
----------	----------	-------	-----------

MONITORING WELLS AT THE CHEMICAL WASTE
DISPOSAL SITE: T115N, R19W, SEC. 35, C.
(See Map p. 13).

Well #1			931.08
---------	--	--	--------

Sand and gravel	0-73		
-----------------	------	--	--

Well #2			910.45
---------	--	--	--------

Sand and gravel	0-30		
Fine sand and gravel	30-40		
Sand and gravel	40-51		

Well #3			928.61
---------	--	--	--------

Sand and gravel	0-40		
Fine sand and gravel	40-65		
Clayish gravel	65-73		

Well #4			928.43
---------	--	--	--------

Sand and gravel	0-73		
Clay and gravel	73-78		

Well #5			929.82
---------	--	--	--------

Sand and gravel	0-78		
Red clay	78-80		
Gray clay	80-110		
<u>Opc limestone</u>	110-120		

Well #6			929.04
---------	--	--	--------

Sand and gravel	0-40		
Sandy clay	40-63		
Sand and gravel	63-72		
Yellow clay	72-83		

Well #7			930.76
---------	--	--	--------

Sand and gravel	0-85		
-----------------	------	--	--

Well #8			921.89
---------	--	--	--------

Sand and gravel	0-20		
Fine sand	20-30		
Sand and gravel	30-65		
Gray clay	65-100		
Opc dolomite chips	at 100		

