

# Gopher Ordnance Works

## East Solvent Area (B Line)

Typical Building Numbers and Names

Building #	Building Name
214B-5	Solvent Recovery Houses
214B-3	Solvent Recovery Houses
214B-2	Solvent Recovery Houses
214B-4	Solvent Recovery Houses
214B-7	Solvent Recovery Houses
214B-8	Solvent Recovery Houses
214B-10	Solvent Recovery Houses
217-A	Knife Grind & Die Shop
214B-9	Solvent Recovery Houses
215-D	Solvent Tank Shelters
214B-13	Solvent Recovery Houses
214B-14	Solvent Recovery Houses
214B-12	Solvent Recovery Houses
214B-15	Solvent Recovery Houses
227-D	Dry Ingredients Storehouse K2SO4
234-M	Vertical Press Houses
234-N	Vertical Press Houses
214	Solvent Recovery Receiver
234-F	Vertical Press Houses
234-G	Vertical Press Houses
234-F	Vertical Press Houses
707-R	First Stage Change House
208-D	Mixer House Macerator & Blocking
208-C	Mixer House Macerator & Blocking
206-B	Ether Mix House
202-P	Dehydrating Press House
202-C	Dehydrating Press House (alcohol added)
202-D	Dehydrating Press House (alcohol added)
746-C	Field Canteen
263-A	DNT Unloading Ramp
215	Solvent Recovery Receiver
214B-1	Solvent Recovery Houses
214B-6	Solvent Recovery Houses
214B-11	Solvent Recovery Houses

Typical Smokeless Gun Powder Line (B)

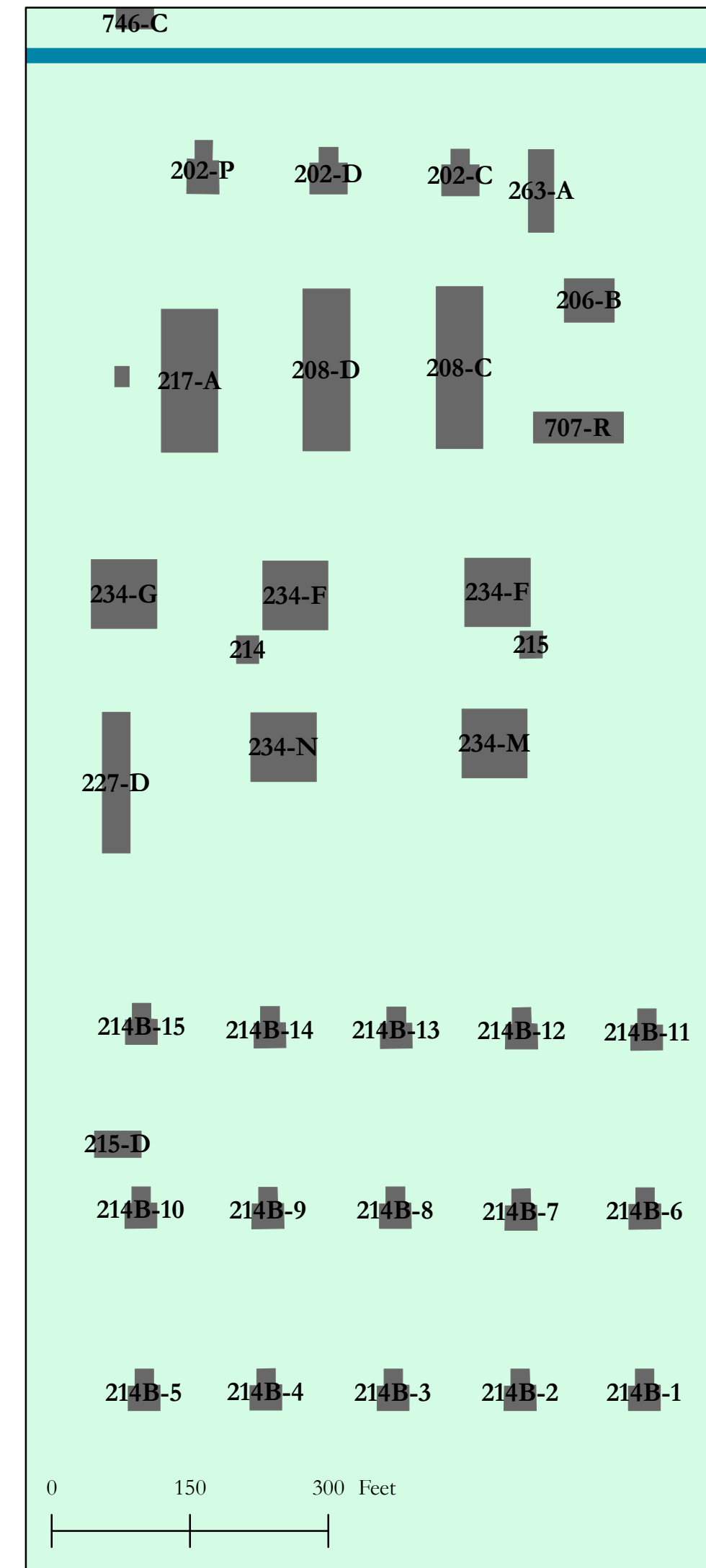

**NOTE**  
D, E, and F Lines  
were never finished.

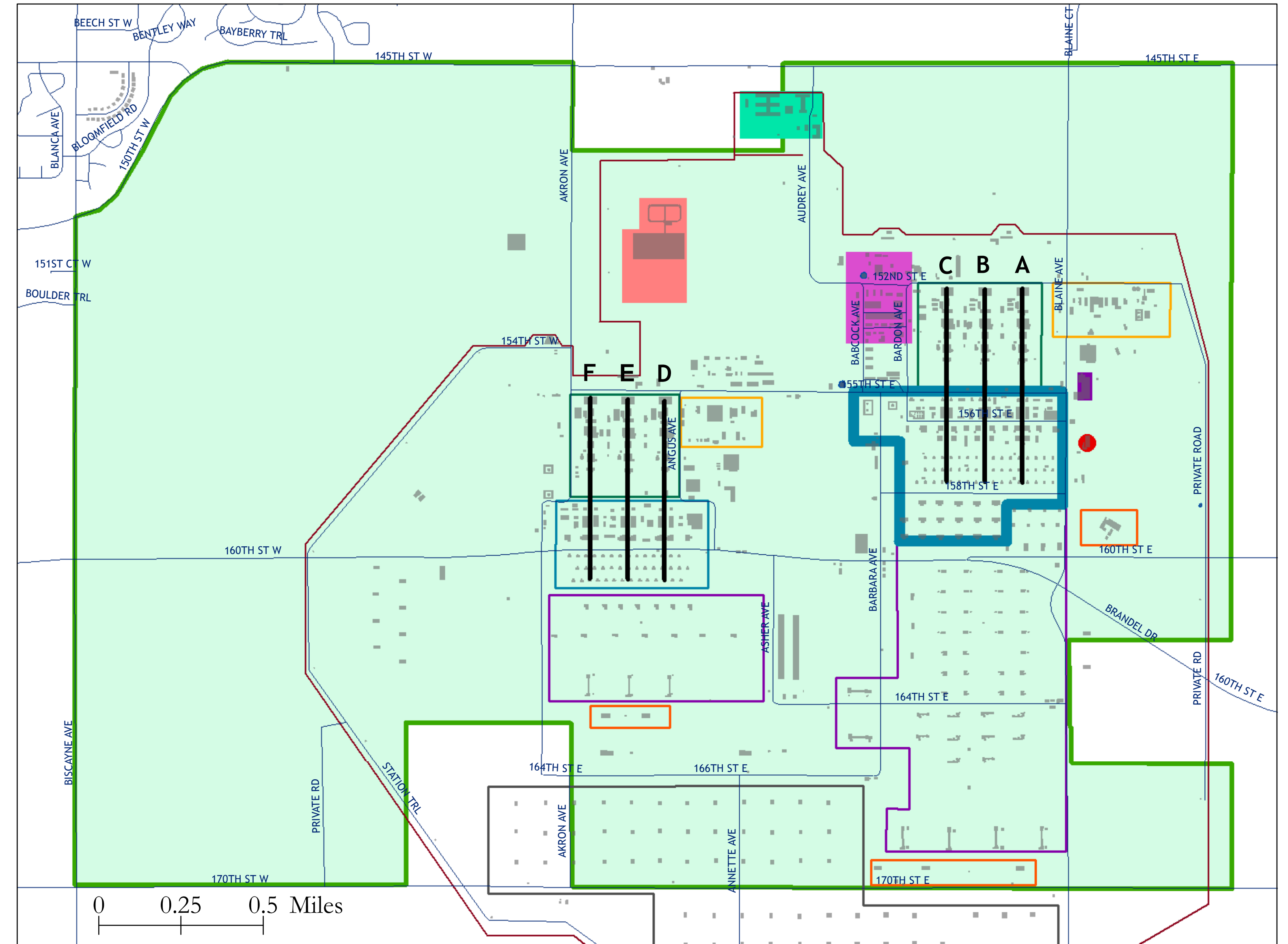

**Key**

- |                             |                        |                  |
|-----------------------------|------------------------|------------------|
| Guncotton Production        | Administration         | Production Lines |
| Solvent Area                | Main Shops Area        | Streets          |
| Powder Manufacturing        | Burning Grounds        | Perimeter Fence  |
| Powder Storage and Shipping | Sewage Treatment Plant | Plant Buildings  |
| Powder Testing              | Power Plant A          | Study Area       |
| Acids and Oleum Plant       | Water Towers           |                  |



This drawing is neither a legally recorded map nor a survey and is not intended to be used as one. This drawing is a compilation of records, information and data located in various city, county and state offices and other sources, affecting the area shown, and is to be used for reference purposes only. Dakota County is not responsible for any inaccuracies herein contained. If discrepancies are found please contact Dakota County Environmental Management Department.