

Gopher Ordnance Works

Main Shop Area

Detail

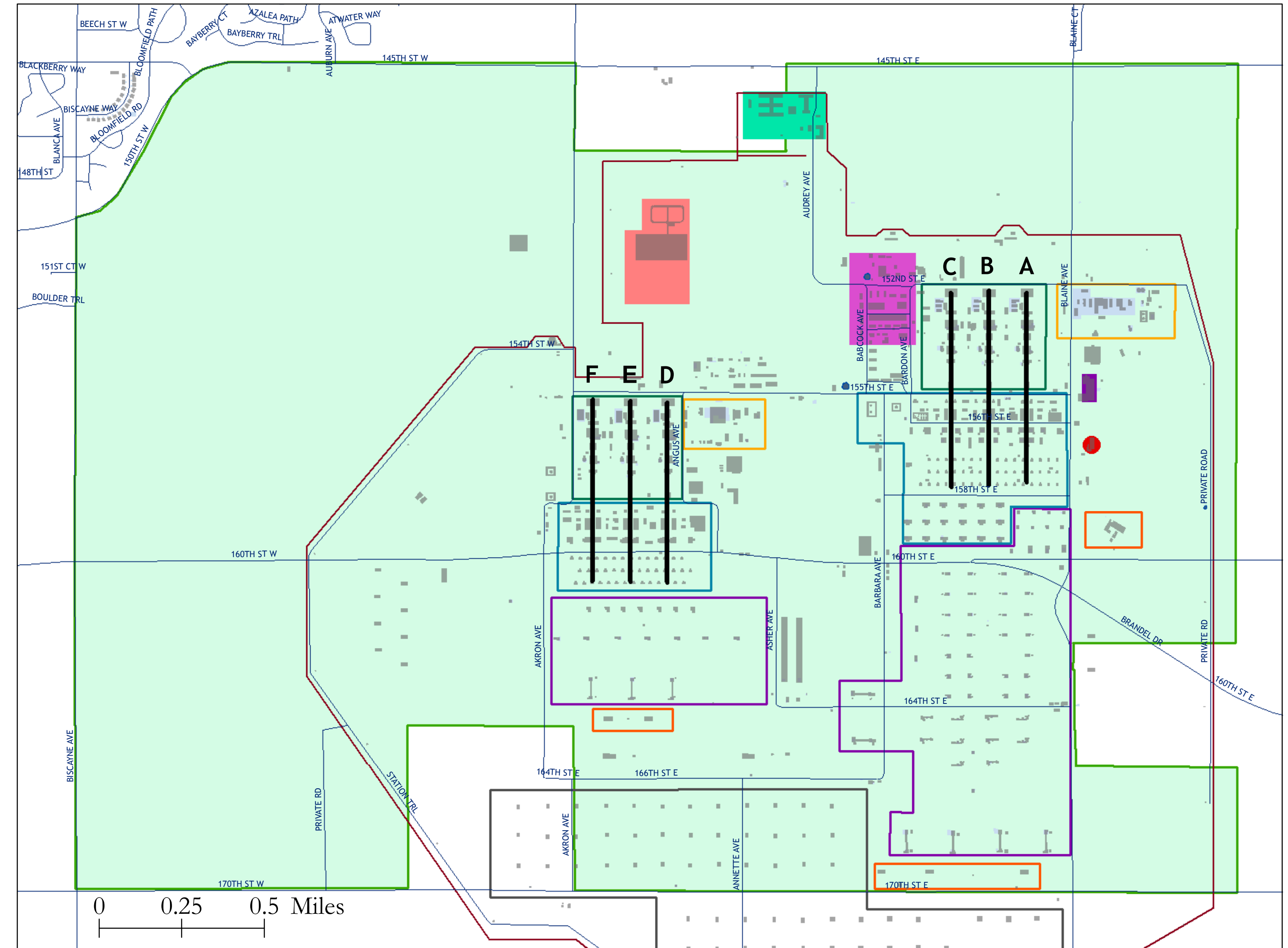
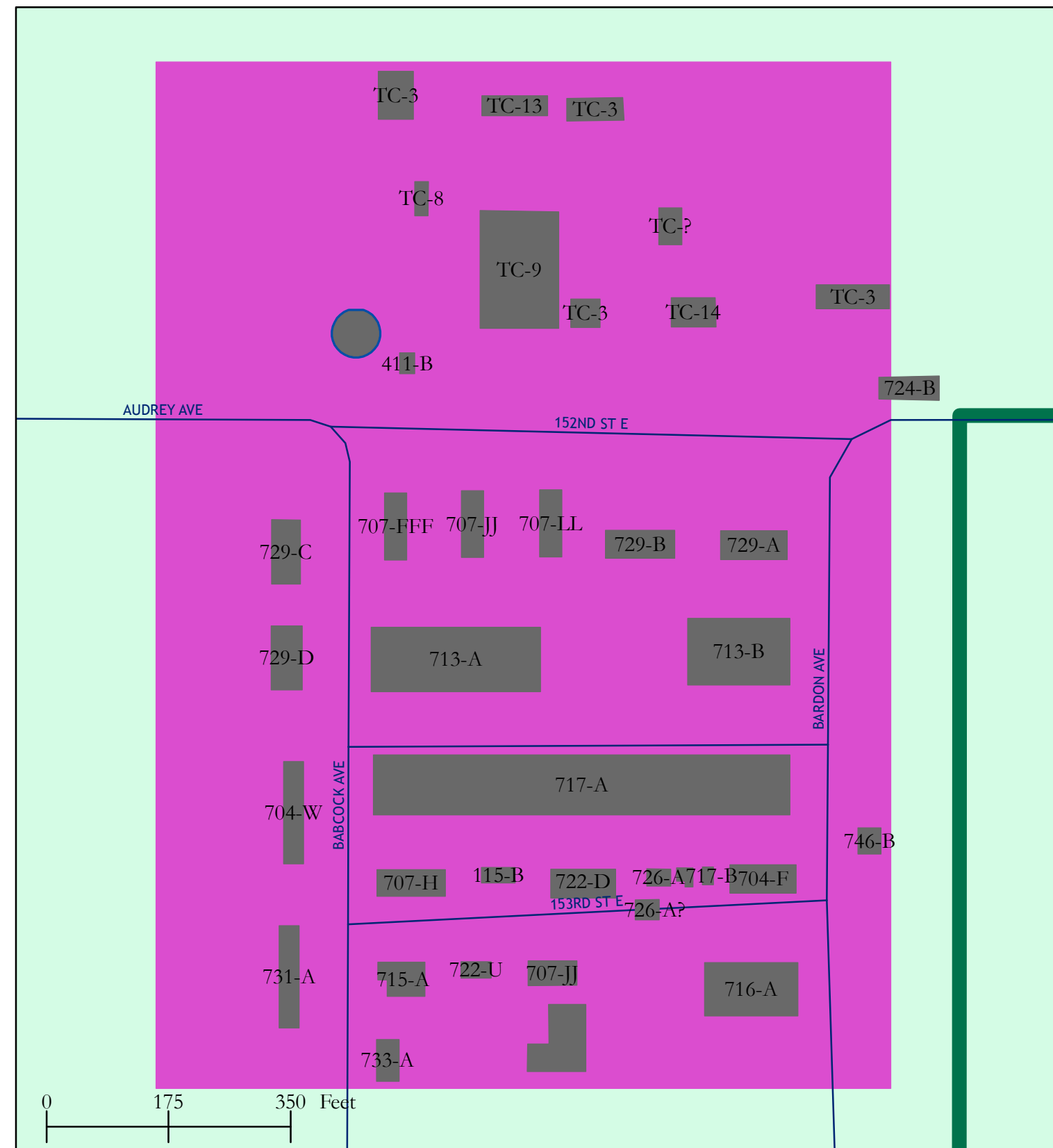

Building #	Building Names	Building #	Building Names
731-A	Salvage Building	707-FFF	Transportation Change House
726-A?	Acetylene Storage	707-JJ	Change House
722-D	Area Shop-paint	707-LL	Shops Change House
707-H	Shops Change House	No Number	Drinking Water Storage Tank
704-F	Sup. Office - Transportation	TC-3	Const Millwright Office
726-A	Acetylene Storage	TC-3	Foreman Shack
726-A	Acetylene Storage		
746-B	Field Canteen	TC-14	Const Paint Rigger Shop
733-A	Service House	TC-9	Const Machine Shop
715-A	Oil and Paint Storage	TC-?	Crane Repair Shop Const.
722-U	Rigger Shop	TC-8	Clock Alley
707-JJ	Transportation Change House	TC-13	Carpenter Shop
716-A	Garage and Repair Shop	TC-3	Foreman Shack
717-A	Combined Shops	TC-3	Foreman's Shack
704-W	Sup. Office-Maintenance		
713-A	General Storehouse	724-B	Gas Station
713-B	General Storehouse	717-B	Sand Blast
729-D	Spare Machinery Storage	No Number	Various Sheds?
729-B	Spare Machinery Storage	115-B	Paint Storage
729-A	Spare Machinery Storage	411-B	Drinking Water Pump House
729-C	Spare Machinery Storage		

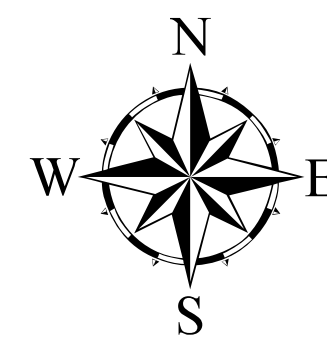

NOTE
Shops are dispersed throughout plant.

Key

Production Areas		Administration	Production Lines
Gun Cotton Production	Main Shops Area	Administration	Production Lines
Solvent Area	Burning Grounds	Sewage Treatment Plant	Streets
Powder Manufacturing	Sewage Treatment Plant	Power Plant A	Perimeter Fence
Powder Storage and Shipping	Power Plant A	Water Towers	Tank Farms
Powder Testing	Water Towers	Plant Buildings	Study Area
Acids and Oleum Plant	Plant Buildings		



This drawing is neither a legally recorded map nor a survey and is not intended to be used as one. This drawing is a compilation of records, information and data located in various city, county and state offices and other sources, affecting the area shown, and is to be used for reference purposes only. Dakota County is not responsible for any inaccuracies herein contained. If discrepancies are found please contact Dakota County Environmental Management Department.